

SCHÄKEL, GERADE FORM_SHACKLE D-FORM

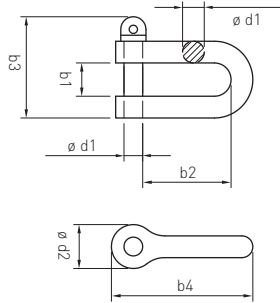

| Artikelnummer Part number | Größe Size | ø d1 | b1 | b2 | b3 | b4 | ø d2 | WLL (to) |
|------------------------------|---------------|------|----|----|-----|-----|------|-------------|
| 835-04 | 0,06 | M4 | 8 | 16 | 24 | 26 | 9 | 0,16 |
| 835-05 | 0,10 | M5 | 10 | 20 | 30 | 32 | 11 | 0,25 |
| 835-06 | 0,16 | M6 | 12 | 24 | 34 | 38 | 12 | 0,375 |
| 835-08 | 0,25 | M8 | 16 | 32 | 46 | 52 | 16 | 0,625 |
| 835-10 | 0,40 | M10 | 20 | 40 | 56 | 66 | 20 | 1 |
| 835-12 | 0,60 | M12 | 25 | 48 | 67 | 76 | 25 | 1,5 |
| 835-16 | 1,00 | M16 | 32 | 64 | 88 | 101 | 32 | 2,75 |
| 835-20 | 1,60 | M20 | 38 | 76 | 101 | 120 | 36 | 3,75 |

Werkstoff 1.4401 | Gemäß DIN82102 | WLL = Tragfähigkeit, gemäß Herstellerangaben
Material AISI 316 | According DIN82102 | WLL = Working load limit according manufacturer's data

ALLE ANGABEN IN MILLIMETERN_ALL DIMENSIONS IN MILLIMETRES